

Courses & distances down the river
from Black Walnut to poplar

N.

B.W N 70¹/₂ E 12 P^s
N 36 E 27
North R3
N 9¹/₂ E 100
N 7¹/₂ E 27
S 62 E 80
S 37 E 110 to poplar

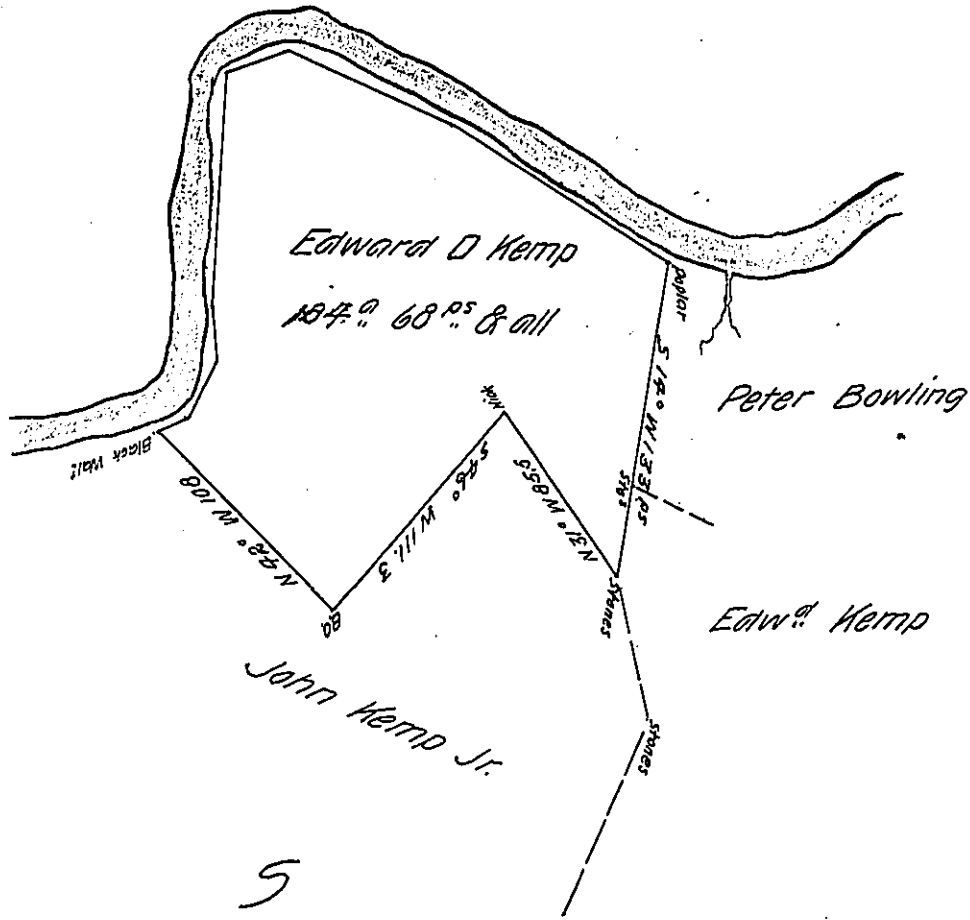

Situate in Addison Township Somerset County on the Youghiogheny River
(or rather the principal branch thereof) & surveyed the 29th day of March 1825
in pursuance of a warrant dated the 15th day of March A.D. 1825
To Gabriel Hiester Jr. Esq. J.G. P.
Certified by Bernard Connelly Jr.
D.S. Saml. G.

IN TESTIMONY that the above is a copy of the original remaining on file in
the Department of Internal Affairs of Pennsylvania, made
conformably to an Act of Assembly approved the 16th day of
February, 1833, I have hereunto set my Hand and caused
the Seal of said Department to be affixed at Harrisburg,
this seventeenth day of July 1905

Joacab Brown
Secretary of Internal Affairs.